



# WELLNESS CENTER AND NCAA PRACTICE FACILITY

UNIVERSITY OF SAN DIEGO



85,000sf, three-story structural steel building housing space for physical and mental wellness, NCAA basketball practice facility, and supporting offices. The building exterior features USD's 16th Century Spanish Renaissance architecture, including plaster, precast and decorative railing. Exterior improvements include a sand volleyball court, soccer play field and basketball court.

## PROJECT RELEVANCY

- Sports Facility
- Office Space
- Meeting/Recreation Spaces

**SQUARE FOOTAGE //** 85,000sf

**CONTRACT VALUE //** \$90,839,179

**EST COMPLETION DATE //** 08/2024

**ARCHITECT //** Tucker Sadler Architects

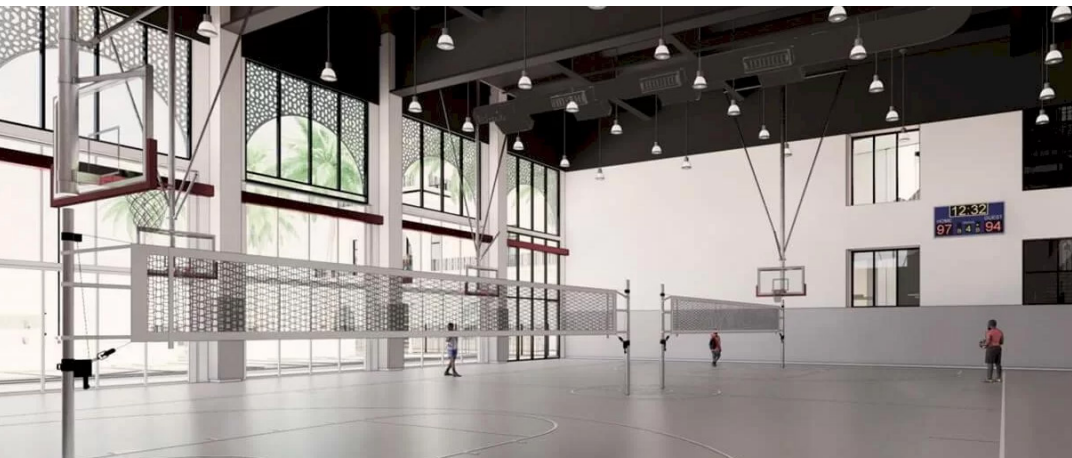





# ENCINITAS ACUTE CARE CENTER

SCRIPPS HEALTH



## PROJECT RELEVANCY

- Phased Construction
- Decommissioning/Demolition
- New Construction
- Tenant Improvements
- Occupied Building

**SQUARE FOOTAGE //** 92,000sf

**CONTRACT VALUE //** \$350,000,000

**EST COMPLETION DATE //** 01/2030

**ARCHITECT //** Taylor Design

A three-story acute care building located in the middle of an existing campus. The project includes phased construction of 92,000sf new construction and 90,854sf of rebuilt hospital space. Also, includes the expansion of the existing critical care building central energy plant and a new loading dock.

The Scripps Encinitas project is the phased decommissioning and demolition of existing buildings 1, 2, 4, 6, 7, and 8 with the phased construction of a new three-story, 224,000sf Acute Care Building (ACB). This work includes the expansion of the existing Critical Care Building Central Energy Plant, a new loading dock, and new landscaping and hardscape on- and off-site improvements.





# VITERBI FAMILY VISION RESEARCH CENTER

UNIVERSITY OF CALIFORNIA, SAN DIEGO



## PROJECT RELEVANCY

- Academic/Medical Campus
- Laboratory Spaces
- Vivarium
- Office Space
- Conference Space

SQUARE FOOTAGE // 100,000sf

CONTRACT VALUE // \$116,000,000.00

EST COMPLETION DATE // 01/2025

ARCHITECT // NBBJ

The Viterbi Research Center is a 100,000sf, ground-up building on an overall project site area of approximately 120,000 square feet. The building structure will be sited on the Health Sciences East Neighborhood of the La Jolla Campus, just west of the Shiley Eye Institute within the existing academic-medical complex. The remaining west half will be restored to a parking lot and open landscaped space. The building will be a combination of wet lab and computational space, along with all supporting spaces including a vivarium, administration area, lecture and conference space and a café.





# DON POWELL THEATER MAIN STAGE AND SECOND STAGE

SAN DIEGO STATE UNIVERSITY



## PROJECT RELEVANCY

- Performing Arts Theater
- Ticketing/Concessions Space
- Office Space
- Renovation

**CONTRACT VALUE //** \$38,663,508.00

**EST COMPLETION DATE //** 05/2023

**ARCHITECT //** HGA Architects and EngineersJ

Design-build renovation of SDSU existing main stage performing arts theater including new audience chamber, lobby, controls rooms, and technical lighting and A/V systems. ADA and fire code upgrade throughout the building. New ground-up Second Stage performing arts building with sound lab, theatrical performance lighting and audiovisual systems. Amenities building for ticketing, concessions and staff offices. Extensive sitework with project location in the center of SDSU campus.

The project involves both gutting and renovating the existing Don Powell Theatre, and building a new second stage that can open up on one side to create a third, flexible indoor/outdoor venue. Another new structure, dubbed the Amenities Building, will house such facilities as a ticket office, concessions and gender-neutral restrooms.





# COPLEY HALL RENOVATIONS

SAN DIEGO SYMPHONY

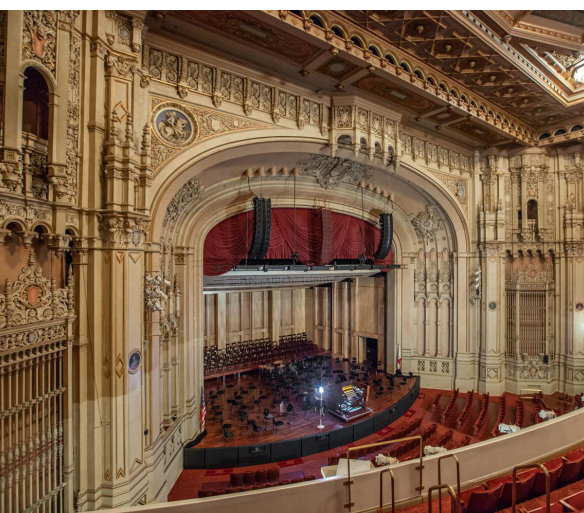

Complete renovation and upgrade of 100-year-old facility with new mechanical and electrical infrastructure, hazardous material abatement and adding 30,000 usable square feet of administration space. Phase 1 included installing new building mechanical and electrical equipment in the interstitial space between the original Symphony Hall roof and the underside of the parking structure for the adjacent office tower. Phase 2 is constructing seven stories of structural steel office space inside the interspatial space between the original Symphony Hall building and adjacent office and hotel towers. Interior construction includes complete modernization of theatrical experience with new rigging, seating terraces, lighting, and audio and visual systems.

## PROJECT RELEVANCY

- Performing Arts Theater
- Office Space

CONTRACT VALUE // \$99,000,000

COMPLETION DATE // 10/20/2023

ARCHITECT // HGA Architects and Engineers